

November 11, 2011

ADDENDUM NO. 1

**DOCTORS HEALTHCARE AND
REHABILITATION CENTER**

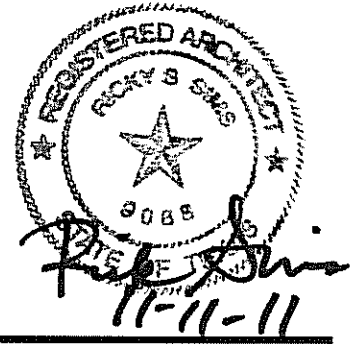

BYSP PROJECT NO. 10106

TO: Arthur Construction Co.

Item No. 1:

Specification 05300: Add the following to description of work, Paragraph 1.01: D. Contractor is to install an anti-freeze loop sprinkler system for each of the two new walkway canopies.

Item No. 2:

Specification 07213: Add the following note at 5. MATERIALS: d. Insulation at ceiling: Minimum of R-30 Kraft-faced fiberglass batt insulation.

Item No. 3:

Specification 07520, 6,h.: Roof sheathing shall be 15mm Magnesiacore NON COMBUSTIBLE SHEATHING in lieu of 3/4" FIRE RETARDANT TREATED PLYWOOD.

Item No. 4:

Sheet D101, D102: At DEMOLITION KEY NOTES add the following NOTE 31: REMOVE LANDSCAPING AS REQUIRED TO PROVIDE ACCESS TO WINDOWS WHERE PTAC UNITS WILL BE INSTALLED.

Item No. 5:

Sheet D101, D102: Change Demolition Key Note #20 to read thusly: REMOVE CEILING AND CEILING INSULATION COMPLETE.

Item No. 6:

Sheet A101, A102: At SPECIFIED ITEMS add the following note: B. ALL SPECIFIED ITEMS SHOWN HERE TAKE PRECEDENCE OVER ANY CONFLICTS WITH ITEMS SHOWN IN THE INTERIORS PACKAGE FROM DIRECT SUPPLY.

Item No. 7:

Sheet A101, A102: Change Interior Elevation Reference at showers to be 26/A501 in lieu of 15/A501 as shown.

Item No. 8:

Sheet A101, A102: At 8 Semi-Private Rooms (205, 206, 217, 218, 235, 236, 247, 248), the short "TV" walls between the beds shall be 6'-0" long. At Semi-Private Rooms 249 and 250 the short "TV" walls between the beds shall be 7'-0" long.

Item No. 9:

Sheet A101, A102: At GENERAL NOTES add the following note: F. WHERE SLAB SAW CUTTING OCCURS, REFILL WITH CONCRETE PER DETAIL 16/A406 (Detail included with this addendum.)

Item No. 10:

Sheet A102: At LIVING B127 and DINING B128, change Window Type M to read as Window Type L for a total of 7.

Item No. 11:

Sheet A301: Door Schedule: At Doors A116, 200, 232, B103 – Change door height to be 7'-0" in lieu of 6'-8".

Item No. 12:

Sheet A301: Window Schedule: Remove Window Type J (with single door opening).

Item No. 13:

Sheet A301: Door Schedule: At Door 232 – Change reference room number to be CORRIDOR 232 in lieu of CORRIDOR 200 as shown.

Item No. 14:

Sheet A301: At Door Type D shall have Fire Glass Panels in lieu of Wire Glass as shown.

Item No. 15:

Sheet A301: The View Panel in Door Type D shall be 36" in length in lieu of 27" as shown so that the bottom of the view panel will be 42" A.F.F.

Item No. 16:

Sheet A401-A404: Roof sheathing shall be 15mm NON COMBUSTIBLE SHEATHING in lieu of 3/4" FIRE RETARDANT TREATED PLYWOOD as shown on 1/A401, 1/A402, 1/A403, 1/A404.

Item No. 17:

Sheet A405, A406: CLARIFICATION – Install all new ceiling insulation.

Item No. 18:

Sheet A406: Add Saw Cut Detail No. 16. See attached sheet A406.1.

Item No. 19:

Sheet A406: Add Column Detail No. 17. See attached Sheet A406.2.

Item No. 20:

Sheet A407: Add Partition Section 5. See attached Sheet A407.1.

Item No. 21:

Sheet A501: TYPICAL RESIDENT SHOWER is mislabeled as No. 15. Change Elevation to No. 26.

Item No. 22:

Sheet ID002: Clarification – All Private Bedrooms to get one TV-1. All Semi-Private Bedrooms to get one TV-1 and one TV-2. TV-3 to be installed at PT GYM B109 and LIVING B127.

Item No. 23:

Sheet P301: At KITCHEN PLUMBING GENERAL NOTES add the following note: NEW GREASE INTERCEPTOR IS TO BE A PRECAST TYPE, 270 GALLON, OLD CASTLE MODEL GT-270 OR APPROVED EQUAL.

Item No. 24:

Sheet E102: Revise Lighting Plan as shown on attached sheet E102.1.

Item No. 25:

Sheet E201: Add Notes 22 and 23 as shown on attached sheet E201.2.

Item No. 26:

Sheet E201: At Rooms 205, 206, 217, 218, 235, 236, 247, 248; Relocate TV Power and Signal outlets as shown on attached sheet E201.1

End of Addendum

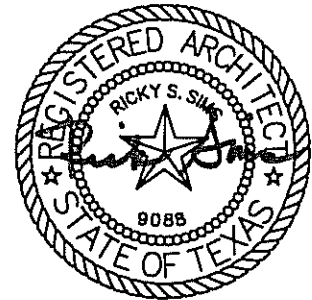

NOVEMBER 2, 2011

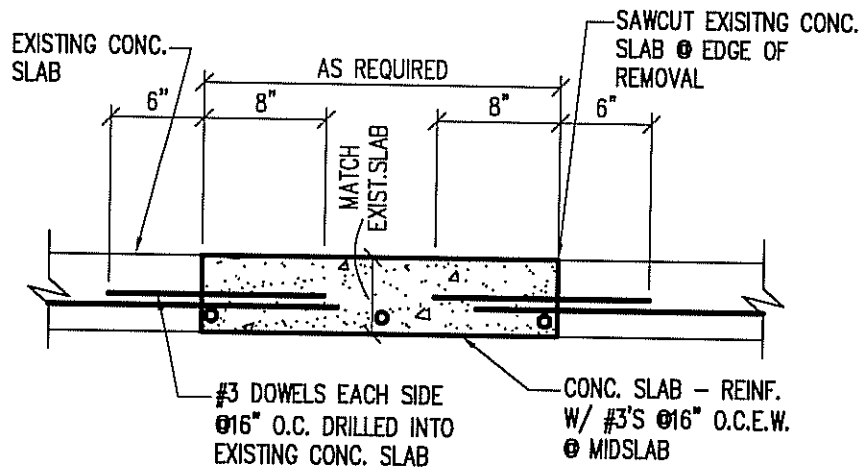

16 SAW CUT DETAIL

SCALE: 1" = 1'-0"

ADDENDUM 1

COPYRIGHT 2011 BUNDY, YOUNG, SIMS & POTTER, Inc.



BUNDY, YOUNG, SIMS & POTTER, INC.
ARCHITECTS/PLANNERS/INTERIOR DESIGN

1005 Ninth St. - Suite 200
Wichita Falls, TX 76301
Tel. (940)761-2404
Fax (940)761-2119

Dick Bundy, AIA Tom Young, AIA(1949-1993) Rick Sims, AIA David Potter, AIA

RENOVATIONS & ALTERATIONS FOR: JOB NO. 10106

DOCTORS HEALTHCARE DATE 11/02/11

AND REHABILITATION DRAWING NO. A406.1

9009 WHITE ROCK TRAIL DALLAS, TEXAS

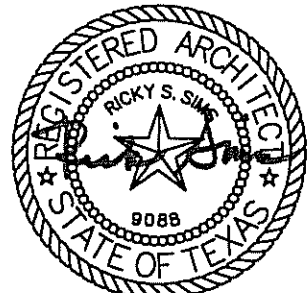

NOVEMBER 2, 2011

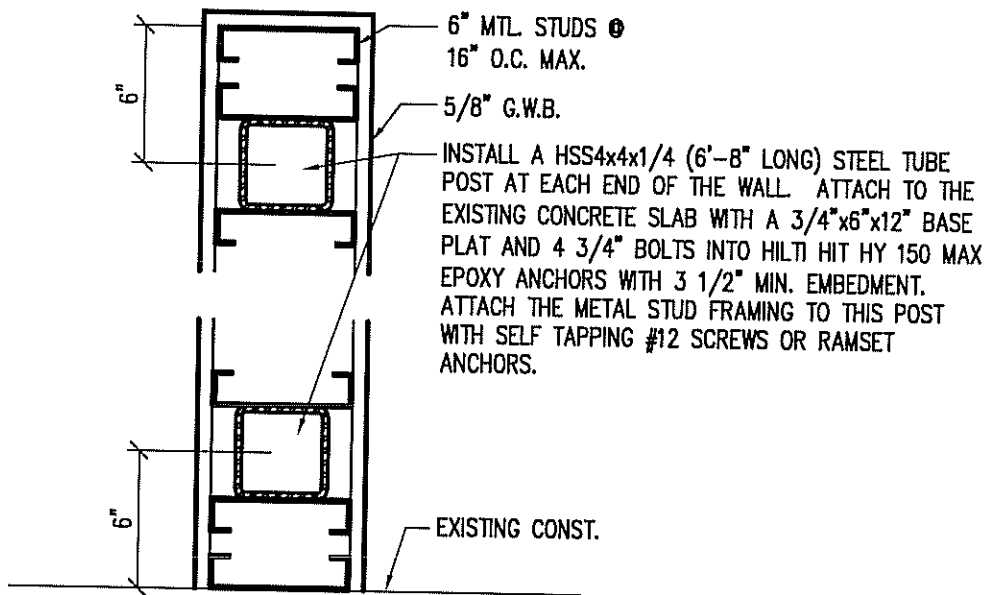

17 COLUMN DETAIL

SCALE: 1 1/2" = 1'-0"

ADDENDUM 1

COPYRIGHT 2011 BUNDY, YOUNG, SIMS & POTTER, Inc.



BUNDY, YOUNG, SIMS & POTTER, INC.
ARCHITECTS/PLANNERS/INTERIOR DESIGN

1005 Ninth St. - Suite 200
Wichita Falls, TX 76301
Tel. (940)761-2404
Fax (940)761-2119

Dick Bundy, AIA Tom Young, AIA (1949-1993) Rick Sims, AIA David Patter, AIA

RENOVATIONS & ALTERATIONS FOR: JOB NO. 10106

DOCTORS HEALTHCARE DATE 11/02/11

AND REHABILITATION DRAWING NO. A406.2

9009 WHITE ROCK TRAIL DALLAS, TEXAS

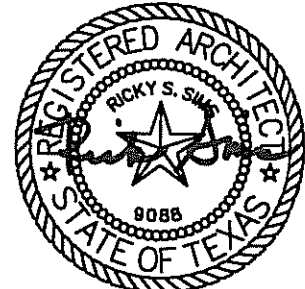

NOVEMBER 2, 2011

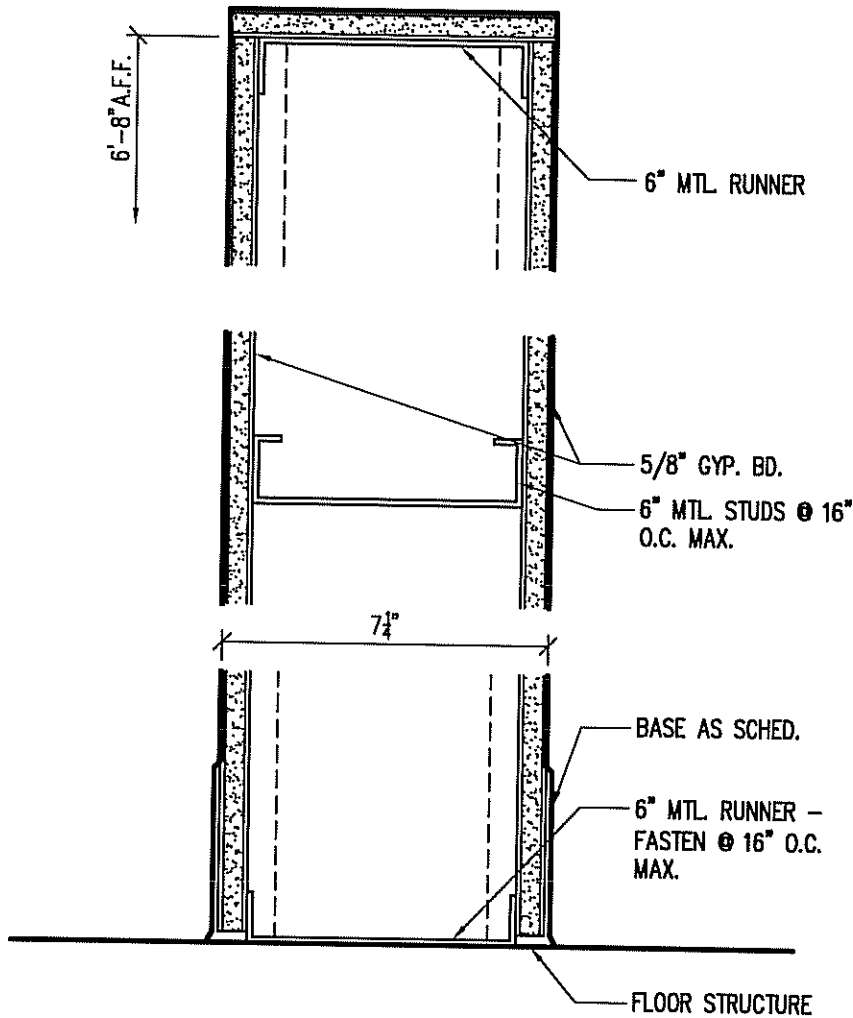

5 PARTITION SECTION

SCALE: 3" = 1'-0"

ADDENDUM 1

COPYRIGHT 2011 BUNDY, YOUNG, SIMS & POTTER, Inc.



BUNDY, YOUNG, SIMS & POTTER, INC.
ARCHITECTS/PLANNERS/INTERIOR DESIGN

1005 Ninth St. - Suite 200
Wichita Falls, TX 76301
Tel. (940)761-2404
Fax (940)761-2119

Dick Bundy, AIA Tom Young, AIA (1949-1993) Rick Sims, AIA David Potter, AIA

RENOVATIONS & ALTERATIONS FOR: JOB NO. 10106

DOCTORS HEALTHCARE DATE 11/02/11

AND REHABILITATION DRAWING NO. A407.1

9009 WHITE ROCK TRAIL DALLAS, TEXAS

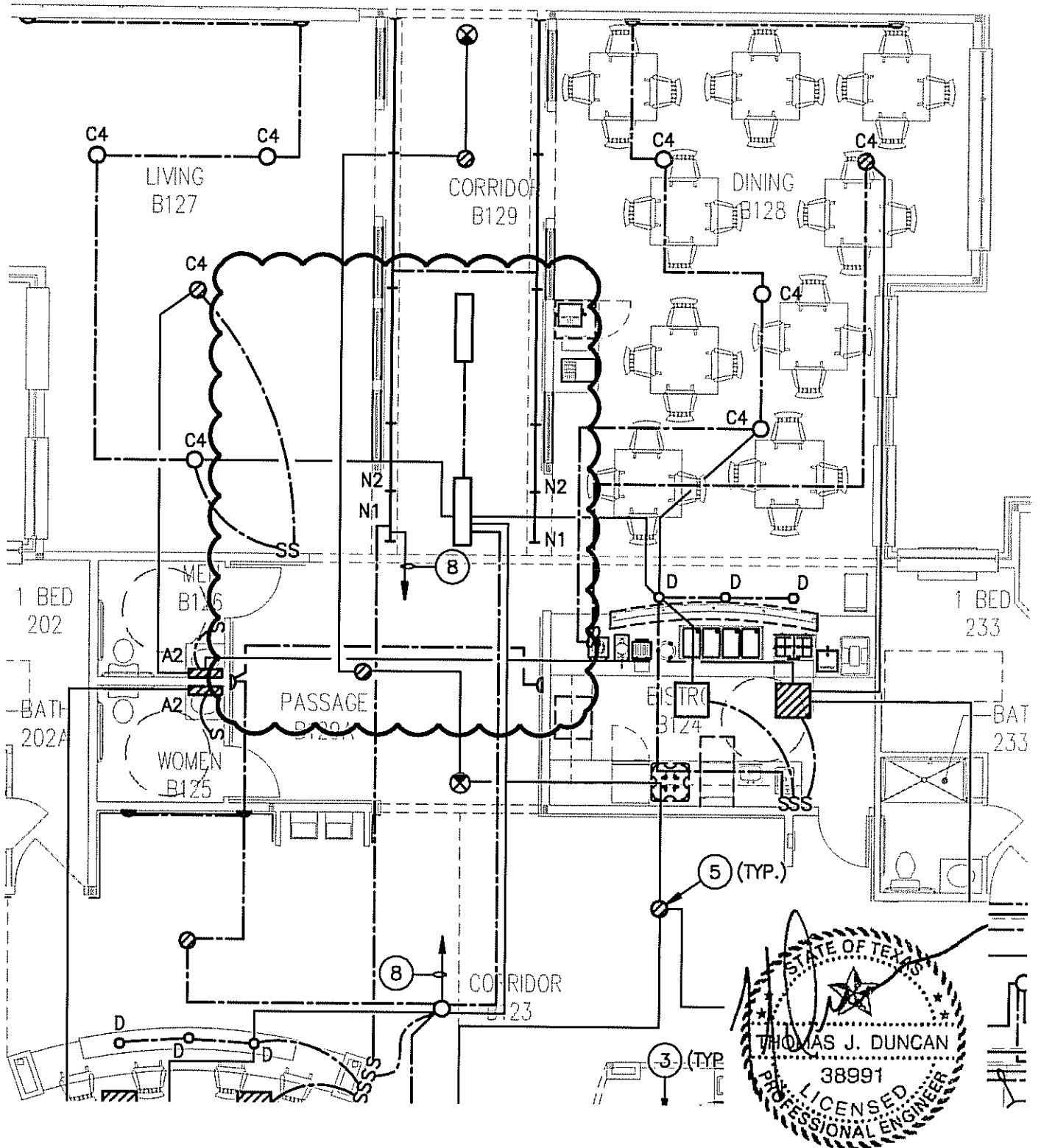

10-24-2011

COPYRIGHT 2006 BUNDY, YOUNG, SIMS & POTTER, Inc.



BUNDY, YOUNG, SIMS & POTTER, INC.
 ARCHITECTS/PLANNERS/INTERIOR DESIGN

1005 Ninth St. - Suite 200
 Wichita Falls, TX 76301
 Tel. (940)781-2404
 Fax (940)781-2118 E-mail: hump@bundy.com

JOB NO. RAI #11036

DATE 11/02/11

DRAWING NO. E102.1

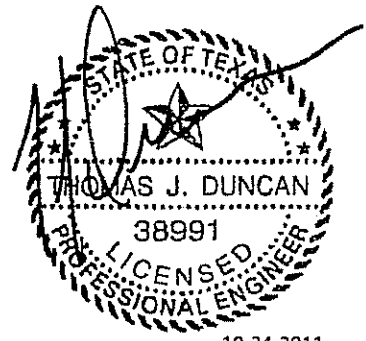
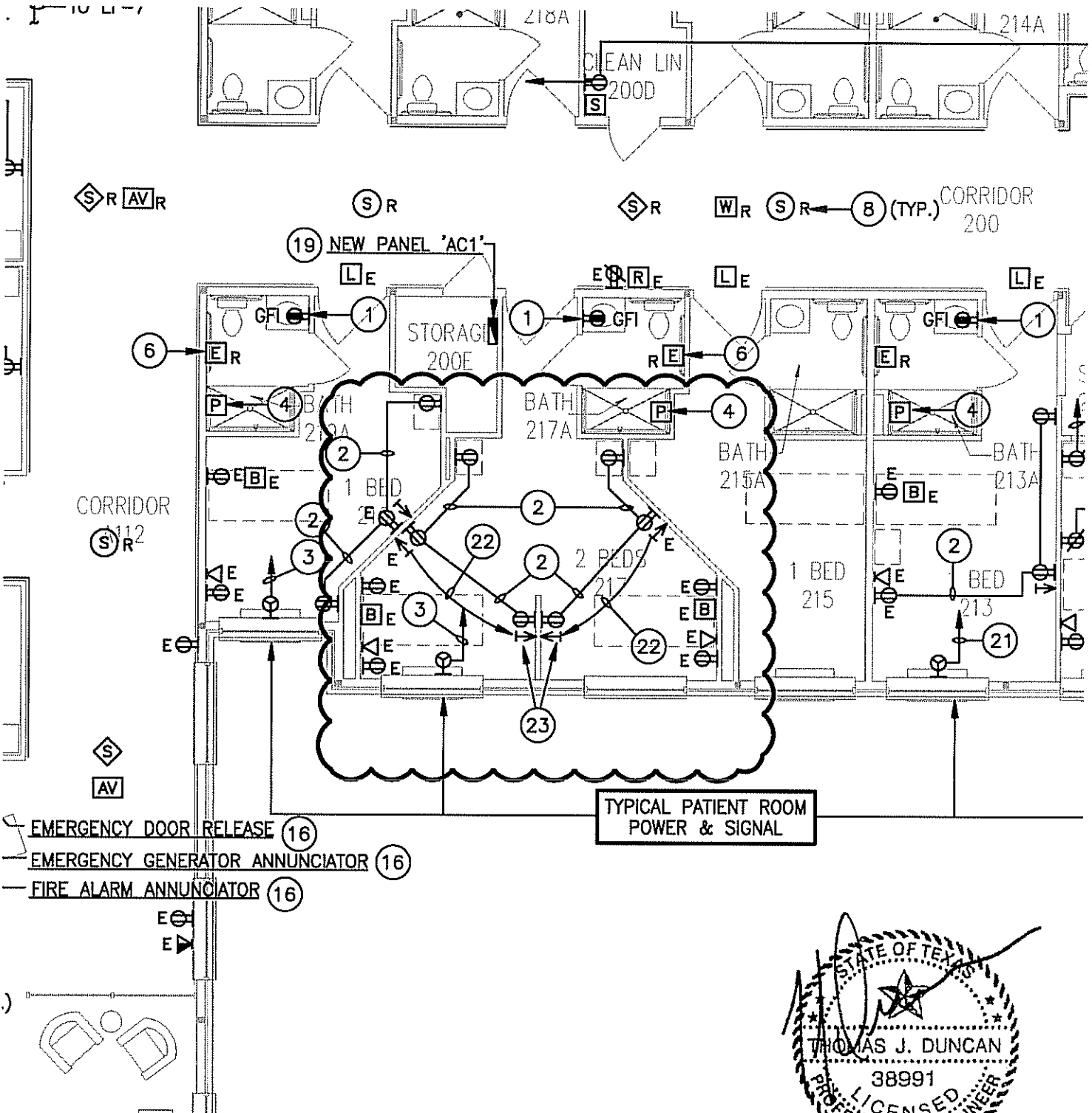

10-24-2011

COPYRIGHT 2006 BUNDY, YOUNG, SIMS & POTTER, Inc.



BUNDY, YOUNG, SIMS & POTTER, INC.
 ARCHITECTS/PLANNERS/INTERIOR DESIGN

1005 Ninth St. - Suite 200
 Wichita Falls, TX 76301
 Tel. (940)761-2404
 Fax (940)761-2119 E-mail: bvo@bvo.com

JOB NO. RAI #11036
 DATE 11/02/11

DRAWING No. E201.1

NOTES BY SYMBOL:

- ① CONNECT TO EXISTING PATIENT ROOM TOILET RECEPTACLE CIRCUIT.
 - ② CONNECT TO EXISTING PATIENT ROOM NON-EMERGENCY RECEPTACLE CIRCUIT.
 - ③ 3 #10-3/4"C., TO 30A. 2P. BREAKER IN NEW PANEL 'AC1'.
 - ④ NEW EMERGENCY WP PULL STATION IN SHOWER. VERIFY EXACT LOCATION.
 - ⑤ CONNECT TO EXISTING PATIENT ROOM EMERGENCY RECEPTACLE CIRCUIT.
 - ⑥ RELOCATE TOILET EMERGENCY PULL STATION.
 - ⑦ RELOCATE NURSE CALL PATIENT BED STATION.
 - ⑧ RELOCATE SOUND SYSTEM SPEAKER.
 - ⑨ RELOCATE FIRE ALARM CEILING SMOKE DETECTOR.
 - ⑩ RELOCATE FIRE ALARM CEILING VISUAL OR AUDIBLE/VISUAL DEVICE.
 - ⑪ RELOCATE FIRE ALARM MANUAL PULL STATION.
 - ⑫ RELOCATE SECURITY SYSTEM DOOR EXIT KEY PAD.
 - ⑬ RELOCATE NURSE CALL MASTER.
 - ⑭ RELOCATE NURSE CALL EMERGENCY PULL INDICATOR LAMP.
 - ⑮ RELOCATE WIRELESS WI-FI DEVICE.
 - ⑯ MATCH AND CONNECT NEW DEVICE TO EXISTING SYSTEMS.
 - ⑰ CONNECT TO SPARE 20/1 BREAKER IN EXISTING PANEL 'A2'.
 - ⑱ CONNECT TO SPARE 20/1 BREAKER IN EXISTING EMERGENCY PANEL.
 - ⑲ CONNECT PANEL 'AC1' TO A NEW (FURNISH AND INSTALL) 225A. 3P. BREAKER IN PANEL 'P1' WITH 4 #4/0, #2G.-2 1/2"C.
 - ⑳ A/C UNIT BEING REPLACED WITH SMALLER TONNAGE UNIT. CONNECT TO UNIT EXISTING CIRCUIT. REPLACE BREAKER WITH A
- ㉑ 3 #12,-1/2 C. TO 20A. 2P. BREAKER IN NEW PANEL 'AC1'.
 - ㉒ RELOCATE TV OUTLET AS INDICATED.
 - ㉓ TV POWER AND SIGNAL OUTLETS 48" AFF, VERIFY WITH OWNER.

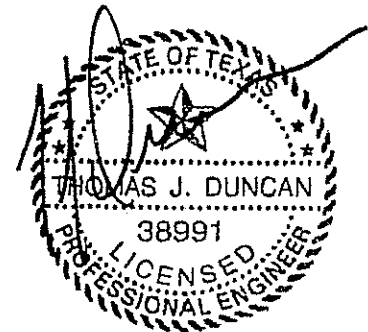

10-24-2011

COPYRIGHT 2006 BUNDY, YOUNG, SIMS & POTTER, Inc.



BUNDY, YOUNG, SIMS & POTTER, INC.
ARCHITECTS/PLANNERS/INTERIOR DESIGN

1005 Ninth St. - Suite 200
Wichita Falls, TX 76301
Tel. (840)781-2404
Fax (840)781-7119 E-mail: bypo@bypo.com

JOB NO. RAI #11036
DATE 11/02/11
DRAWING NO. E201.2